

## NFB™ 4.2 ROTARY STEERING

### APPLICATIONS

NFB 4.2 single-cable systems are suitable for most single-station boats with a single non-power-assisted outboard and sterndrive engines up to V-6 and minimal engine flutter or steering instability.

4.2 accepts wheels up to 16" diameter.

Use dual cable system for boats with engine flutter or steering instability.

Replaces nearly all SeaStar Solutions Safe-T® steering systems (including twin cable) without dash modification.

### FEATURES

- Patented No FeedBack™ Steering mechanism.
- Twin cable system available for maximum control.
- Comfortable 4.2 turns from lock-to-lock.
- Standard 3/4" tapered steering shaft.
- Stainless steel cable output ends.
- Fast, easy installation: uses SeaStar Solutions Quick Connect (QC) steering cable.

Issue Date - Sept 2013

Issue Number - ms6



NFB™ 4.2 Single Cable System  
(Steering Wheel not included.)

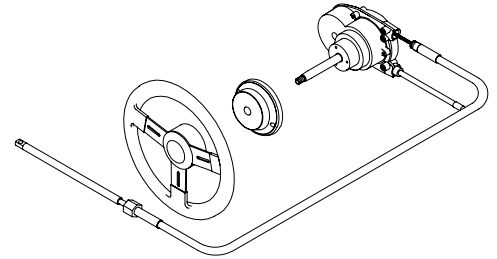

NFB™ 4.2 Dual Cable System  
(Steering Wheel not included.)

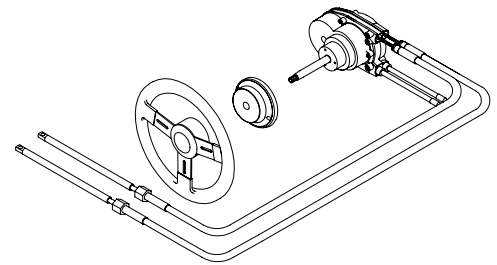

Patented No FeedBack Steering Control for about the cost of an old-fashioned steering replacement. With the advantage of 4.2 turns lock-to-lock and our patented No FeedBack steering to lock out steering loads, SeaStar Solutions 4.2 Rotary NFB Steering is the ideal single-cable system for most non-power-steered boats. The rugged dual cable system is made for applications with engine flutter or steering instability. The helm is a drop-in replacement for current generation Safe-T with no dash modifications required.

### ORDER INFORMATION

COMPLETE SYSTEMS	PART No.
NFB 4.2 Steering Kit (Single Cable) (kit in lengths of 10 ft - 20 ft)	SS147XX
NFB 4.2 Dual Steering Kit (Dual Cable) (kit in lengths of 10 ft - 20 ft)	SS148XX
COMPONENTS	
NFB 4.2 Helm	SH4910P
NFB 4.2 Dual Helm	SH4920P
QC Cable (2 required for dual system)	SSC62XX
Rotary NFB Bezel (90°)	SB27150P





## NFB™ 4.2 ROTARY STEERING

### FEATURES

- Kits include: cable (2 Cables for dual system), helm, 90° bezel and hardware.
- Meets A.B.Y.C. standards.
- Meets N.M.M.A. certification requirements.

### ORDER INFORMATION

OPTIONS	
NFB 4.2 Single Tilt Dash Module, Each Kit Includes Tilt Helm & Tilt Mechanism	SHT91526
NFB 4.2 Single Tilt Helm	SH91526P*
NFB 4.2 Dual Tilt Helm	SH91527P*
Sport Tilt Mechanism	SH91800P
Sport Plus Tilt Mechanism	SH91900P
Bezel (20°)	SB27483P
Cable Gard (fits most tilt tubes)	SA39329P
SERVICE ITEMS	
QC II Cable (for most SeaStar Solutions rotary) (Includes SA27620P Helm Converter) (2 required for dual system)	SSC61XX
Steering Wheel Hardware Kit (Old #2745417P)	SA27454P
Spent Travel Tube (Rotary NFB)	SA38603P

\* Requires Tilt mechanism to complete tilt steering system installation  
XX = Length in feet

Issue Date - Sept 2013

Issue Number - ms6



Learn More



[www.seastarsolutions.com](http://www.seastarsolutions.com)

