

Easy Glide sleeper sofa Assembly Instructions

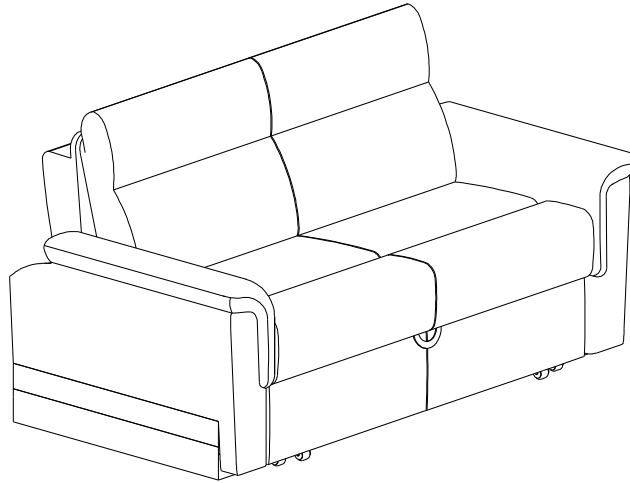

1. Locate the small red plastic tool/parts kit inside the smaller "ARM" carton. Inside are the small wrench and L shaped hex head screwdriver and hardware.
2. Place the large seat cushion section face down on a soft assembly area, such as carpet or blanketed area to protect the cover.

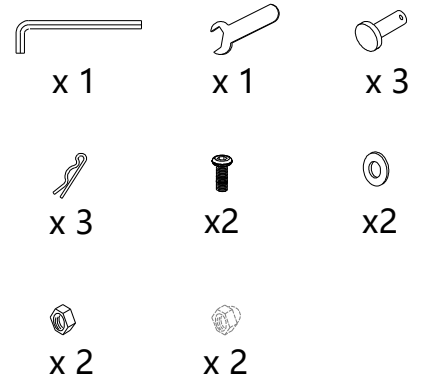
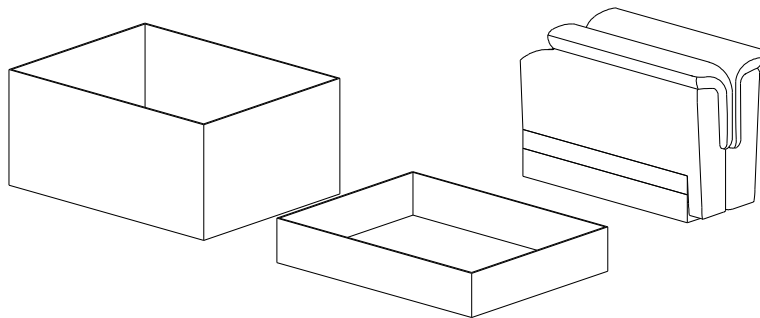

3. Snip the plastic zip tie on the back of the metal frame to loosen the frame for sliding upward.

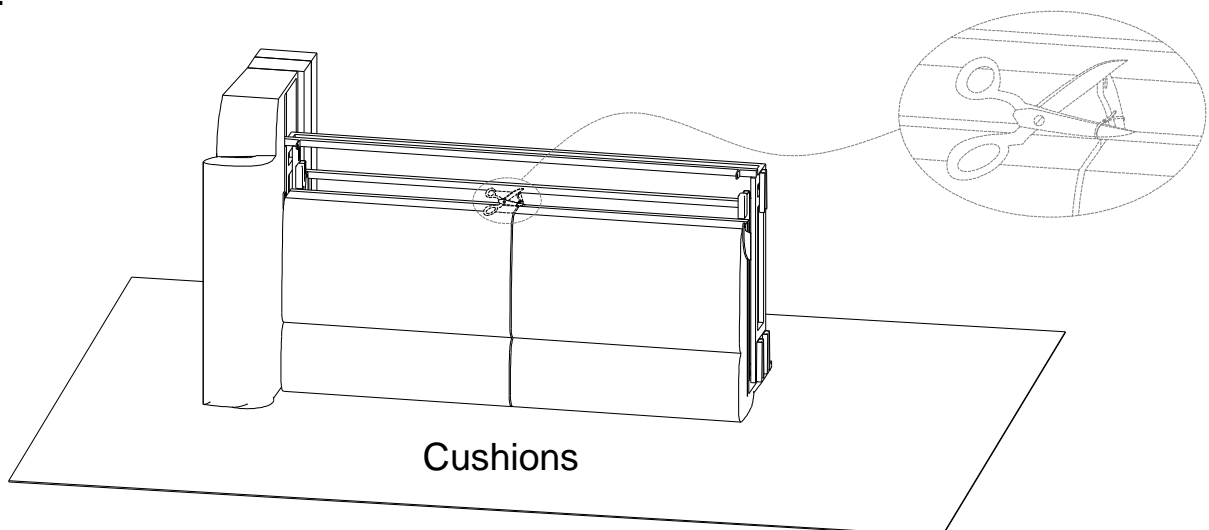

4. Place one of the arms with the front down along side the seat section and note the 3 wedge-shaped brackets that will slide into the matching slide brackets of the arms. Lift the metal rails upward a few inches to allow for the metal brackets of the arm and cushion section to drop inside of each other. Make certain that ALL 3 of the metal brackets are engaged, then push downward securing the brackets fully into each other, thus attaching the arms. Once fastened tightly, then attach the second arm onto the other side of the seat cushion.

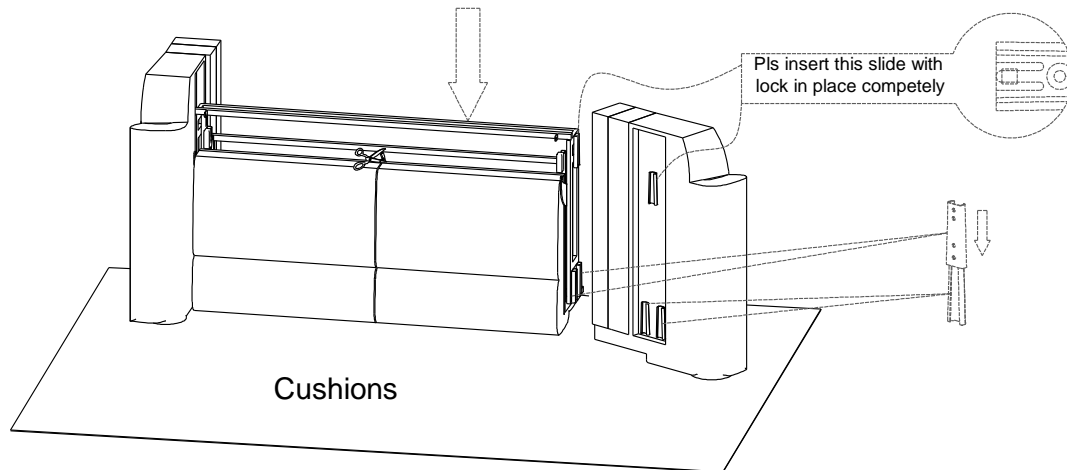

5. Pls use the 2" self tapping screw to go through the hole of the back bracket, then tighten the self tapping screw clockwise, so as to fasten the arms.

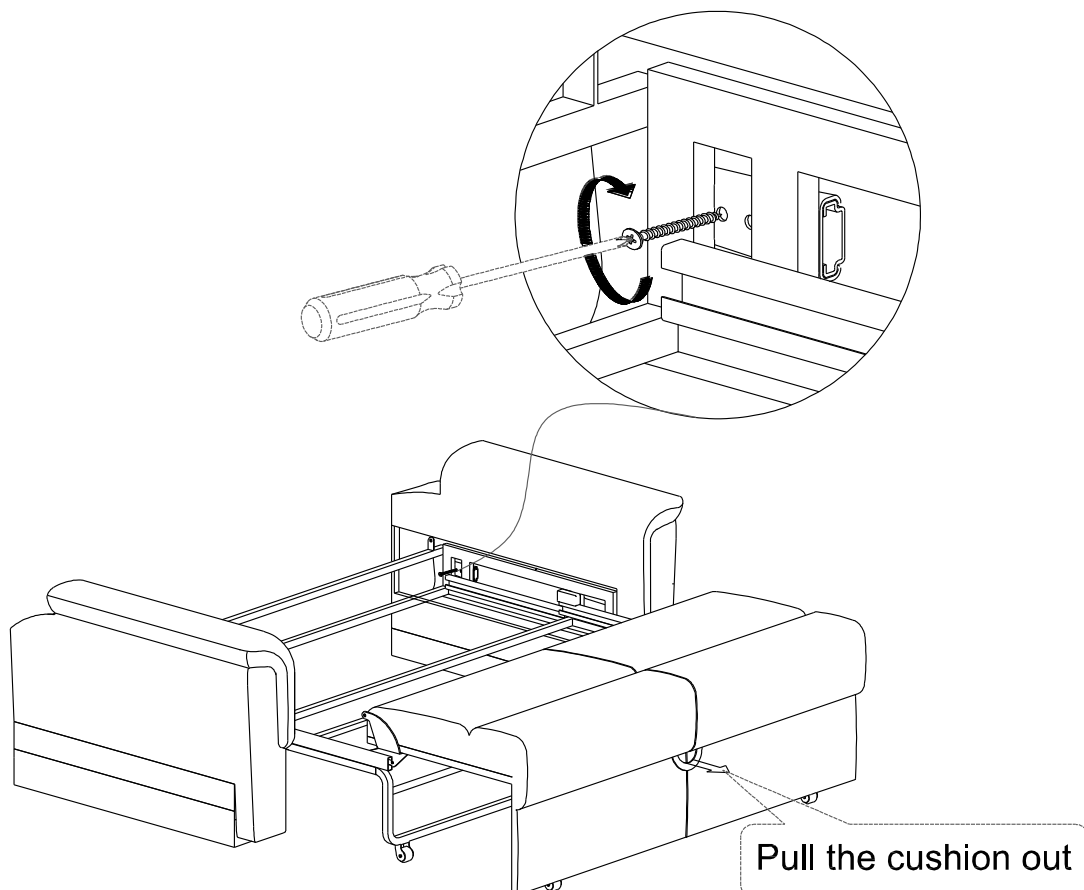

6. Attach the back cushion onto the back of the seat cushion using 2 pins that are fastened into place using small cotter pins.

Simply push the pin through the seat and back rest holes and place the cotter pin through the small hole.

The back cushion should pivot freely on these two attachment points

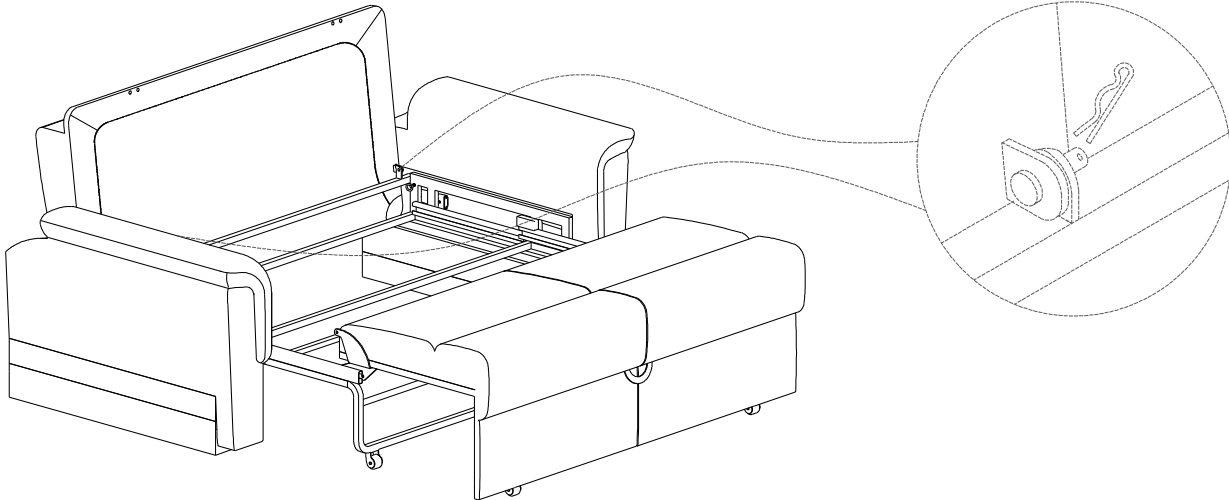

7. Take the front of the back cushion and place the male brackets into the female brackets on the back of the back cushion pads. They simply slide onto the brackets from the side.

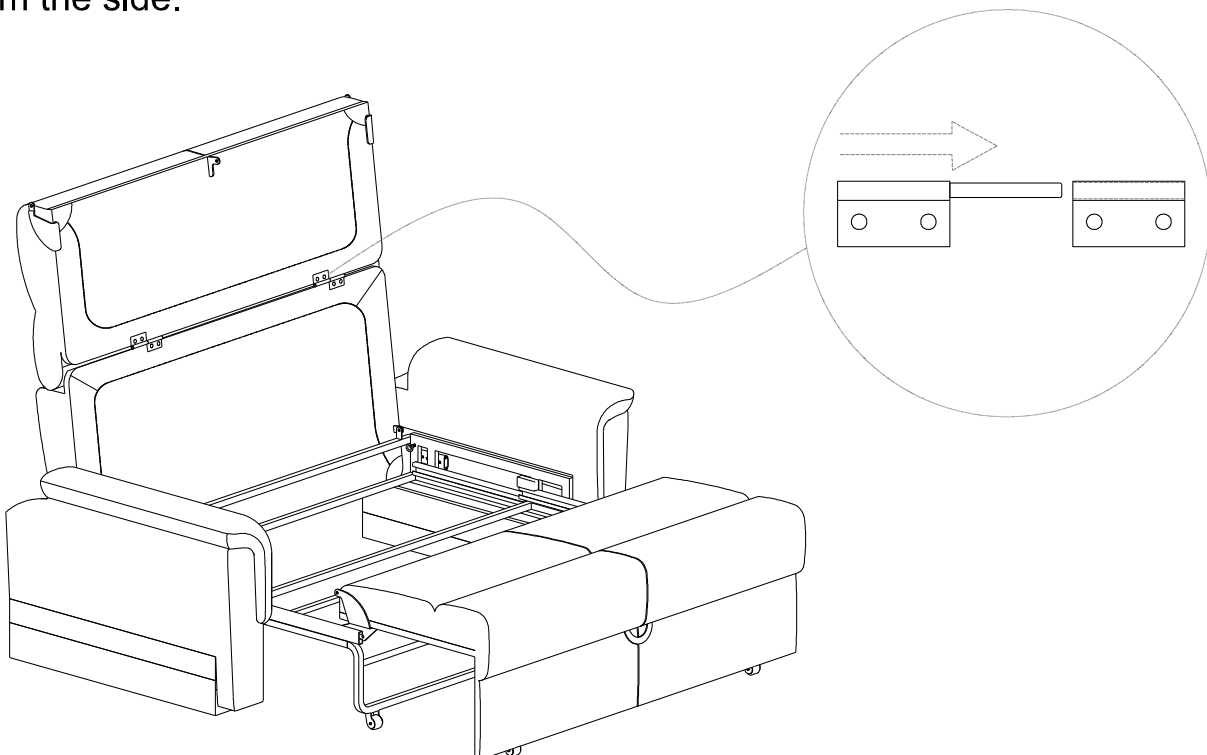

8. Lower the 2 back cushion pieces down over the opened back frame.

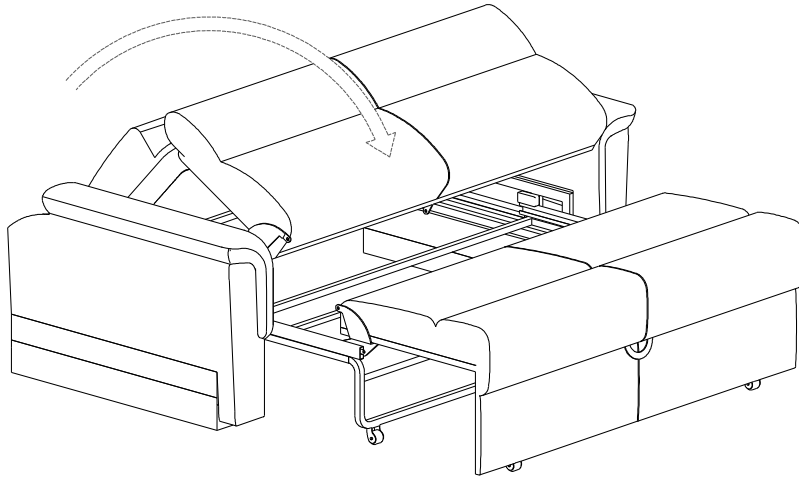

9. Fasten the crescent frame on each side of the bed frame. Use the 2 one inch bolts that go through the holes with the heads on the outside of the frame. Using the small wrench and L screwdriver, attach a nut on the inside of the hinge and then screw on a black plastic end cap to protect the sofa cover.

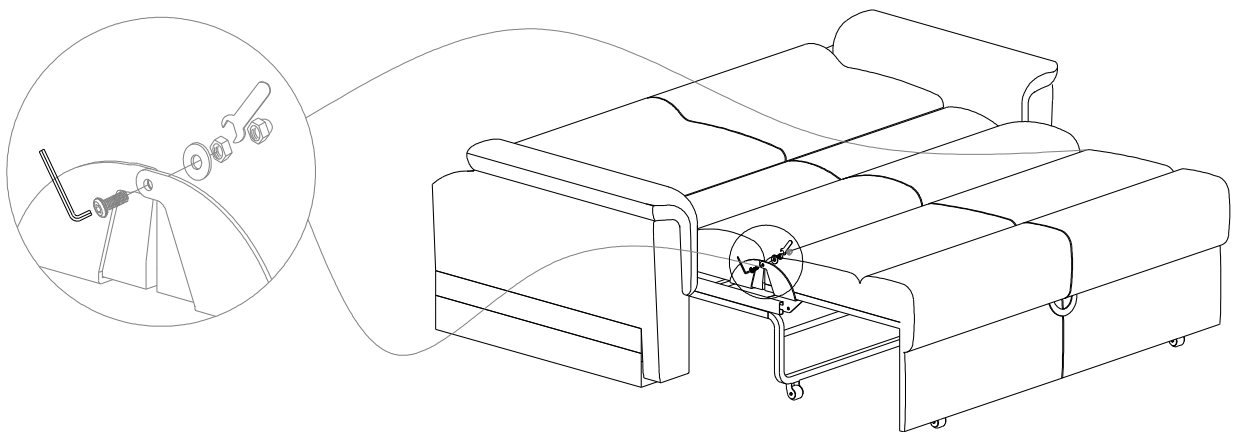

10. Last, lift (or prop up) the front of the sofa and attach the curved, tooth-edged bracket to the underside of the back frame. Use the same pin and cotter pin and used in step #6 above.

This curved bracket is important to make the bed open and close properly.

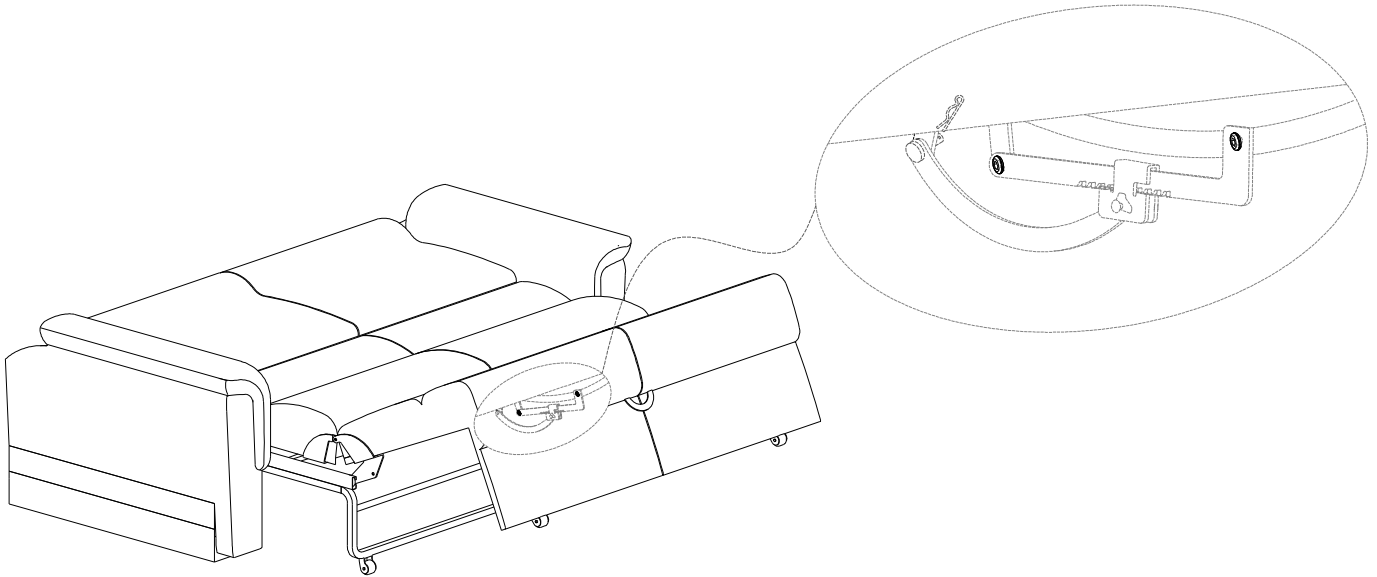

11. Now place the sofa front back onto the floor. To close the sofa simply pull the front strap upward about 5-6" and you'll hear a slight click.

Do not pull the front of the sofa more than 8" because it will not engage the metal notches on the bracket.

When you place the sofa front back down on the floor, see that it will make the seat rise up slightly .

Simply push the body of the sofa back into the seating position. It may be a snug push depending on friction of the cover being used.

RAISED FLOOR APPLICATION:

Installation of a NOTCHED Sofa onto a RAISED slide out

A notched arm sofa is used in many RV's that have raised slide outs.

Slide out sizes vary depending on the manufacturer, thus these guidelines are more general.

1. Pay close attention when removing the OLD sofa from the slide out, noting where and how it is fastened in place.

Fasten the L brackets to the inside of the arm first before putting into the unit.

2. Measure the height of the raised floor slide and depth of the slide out when open.

3. Note that the new NOTCHED sofa has 2 inserts already attached beneath each arm. 1 is 3" thick, the other is 4" thick (see photo). With the 2 inserts attached, the unit will sit correctly on a flat surface. The front of the arm should be appx. 1" above the floor to allow the wheels to roll properly for opening.

4. Each insert is attached at the bottom with 2 screws, to remove simply unscrew and remove either one or both of the inserts. You may switch the inserts or reapply in order to fit the height of the slide out.

5. Example of measuring the slide out: This drawing shows a 3" insert being added to a sleeper sofa, to match a 4" height of the slide out.

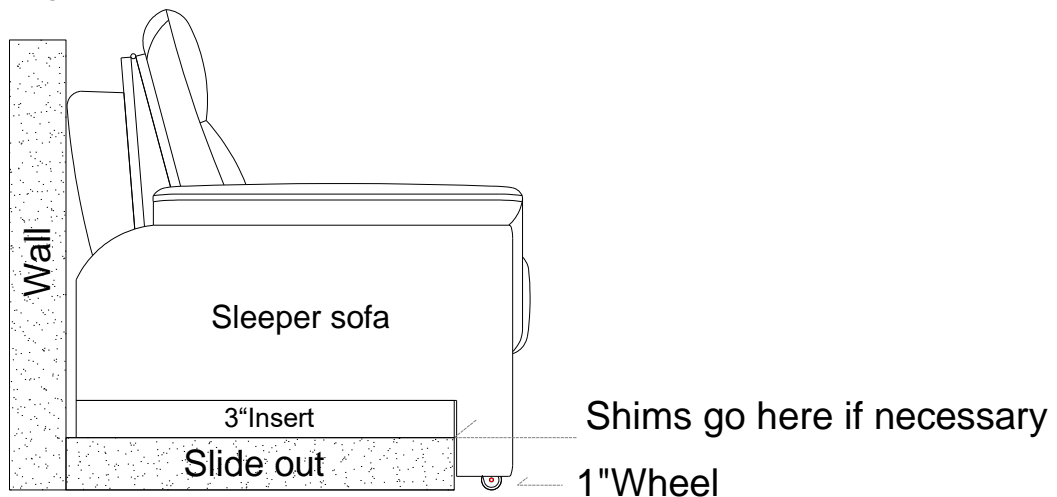

6. The 2 inserts are for use with: level floors, "7", "4", "3" raised floors. Simply change out the inserts to match the slide out height. Keep in mind that the front of the arm MUST be 1" off the floor to account for the wheels and must be parallel. With BOTH inserts removed, the notch is 7" high including 1" for the wheel.

7. If you have another slide out height simply add some 1" shims, or similar shims between the bottom of the arm and the top of the slide out to make up the difference. It will not be visible because the arm sides will be hidden by the side walls.

8. Slide the sofa onto the slide out to make sure it fits, the wheels touch the floor and the sofa is level. Open and close the bed unit as a trial.

9. Fasten the sofa to the floor or other solid place using an L bracket or the fastening parts from the old sofa.

The bed will likely need to be partially open to screw the fasteners on the inside of the arm frame and floor.

but first check the location as to where it should be fastened to the floor.

10: The Easy Glide sofa series, with and without a notch, will all function in the same way. Please ignore this reference to notches and raised floors if your unit has a flat floor, with no raised slide out.